

QUESTIONARIO

Questionario molle a spirale Spring covers question form

Posizione di lavoro sulla macchina Work position on the machine



Orizzontale
Horizontal



Verticale
Vertical



Trasversale
Transversal

Opzionale Optionally

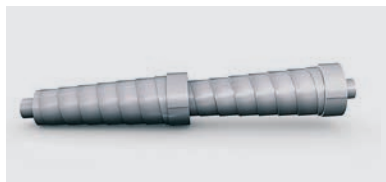

Molle a spirale in serie
Spring covers in a row

Dati Data

Diametro interno D_1 : _____ mm
Internal diameter D_1 : _____ mm

Lunghezza pacco aperto A_Z : _____ mm
Extension length A_Z : _____ mm

Pacco chiuso Z_D : _____ mm
Compressed Z_D : _____ mm

Condizioni ambientali (polvere, temperatura ecc.): _____ mm
Environmental conditions (dust, temperature, etc.): _____ mm

Uso di emulsionanti: _____ mm
Use of emulsions: _____ mm
Tipo e quantità in mm
Type and quantity in mm

Velocità: _____ m/min
Travel speed: _____ m/min

Materiale: Acciaio per molle, blu lucido
Material: Spring cover steel, blue polished
 Acciaio inossidabile
 Stainless steel

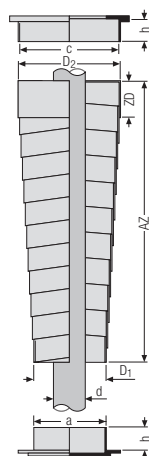

QUESTION FORMS

Esempio d'ordine Order example

025 – 0100 – 020 V 0

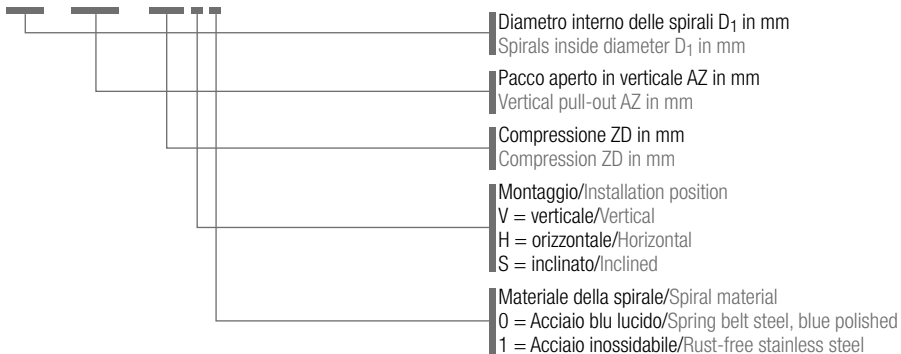

Codice d'ordine:
Order specification: _____ – _____ – _____

Fabbisogno:
Requirement: _____ Pezzi/pieces